

Elstree Way, Borehamwood

£320,000 (Leasehold)

VILLAGE
E S T A T E S



This 2 bedroom, 4th floor apartment is located in the highly regarded and sought after block, Elstree House. Built to a very high standard with features including:- on site concierge weekdays from 9.00am - 3.00pm, 24 hour cctv, onsite gymnasium, gated parking, luxury kitchen with granite work surface, bi-folding glass doors to balcony and natural oiled engineered oak flooring to hall and living areas. Internally this stunning apartment boasts a large entrance hall, open plan kitchen/living/dining area with access to parking, master bedroom, second bedroom and a family bathroom. The property also comes with a secure allocated parking space with plenty of visitor spaces available on a first come first served basis.

Located on Elstree Way with fantastic road links to A1 and M25, approximately 1.2 miles from Elstree & Borehamwood mainline station which can be reached by bus with the stop on the door step, Borehamwood High Street, an array of good schools and places of worship are also close by.

020 3764 2222
www.village-estates.co.uk



Village Estates
The Corner Shop High Street, Elstree
Herts WD6 3BY

Important Note: These particulars do not form part of any contract. All measurements are approximate and should not be relied upon. All prices quoted are strictly subject to contract.







Approx Gross Internal Area
54 sq m / 582 sq ft

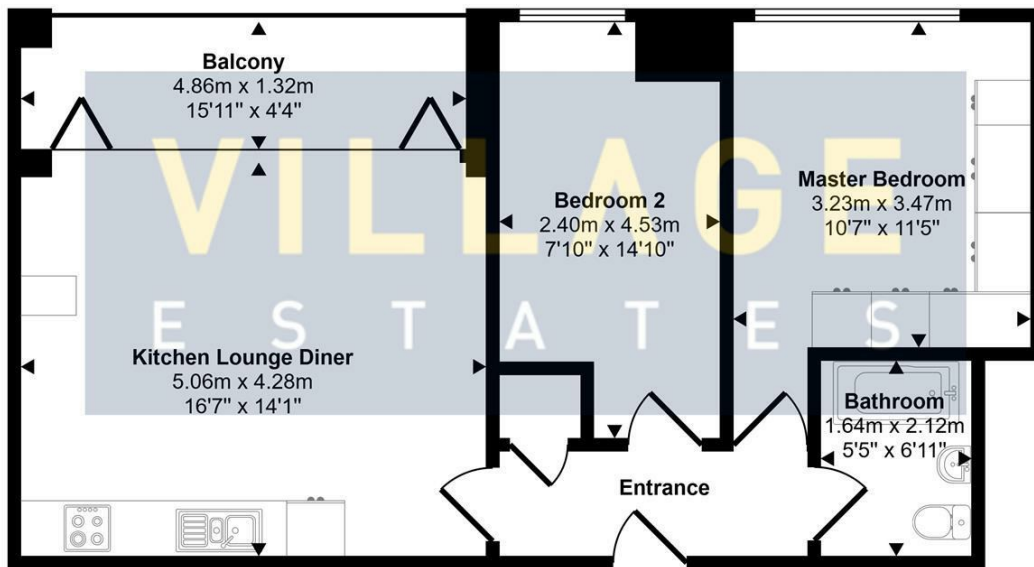

Floorplan

This floorplan is only for illustrative purposes and is not to scale. Measurements of rooms, doors, windows, and any items are approximate and no responsibility is taken for any error, omission or mis-statement. Icons of items such as bathroom suites are representations only and may not look like the real items. Made with Made Snappy 360.



Energy Efficiency Rating		Current	Potential
Very energy efficient - lower running costs			
(92 plus) A			
(81-91) B			
(69-80) C			
(55-68) D			
(39-54) E			
(21-38) F			
(1-20) G			
Not energy efficient - higher running costs			
England & Wales		EU Directive 2002/91/EC	